

EMP Protector-N-Li

EMP Protection - In-Line DC-3000 MHz
Commercial and Marine Antennas



EMP-Protector-N(f)-N(m)-230 model shown
(see table for options)



EMP-Protector-N(f)-N(f)-230 model shown
(see table for options)



Gas Discharge Tube (GDT)
replaceable module

Application

In-line EMP-Protector is equipped with a gas discharge tube (GDT) surge arrester device that protects personnel and electrical equipment from damaging high voltage transients induced by lightning, inductive switching, or electrostatic discharge.

The GDT module can be easily replaced after a strike or surge.

The unit can be earthed using an M4 screw connection or supplied solder/crimp tag.

Electrical Specifications

Frequency Range	DC-3000MHz
VSWR	< 1.3:1
Impedance	50 Ω (nominal)
Power Rating	25W or 150W (see table)
GDT	90 V or 230V (see table)
Insertion Loss	0.2 dB maximum
DC	DC continuity for remote powering
Connectors	N Type (see table)

Mechanical Specifications

Grounding	M4 screw connection or crimp/solder terminal
Housing	Nickel plated brass
Weight	130 g
Length	65 mm - see drawings
Insulation	PTFE
Temperature Range	- 55°C to + 71°C

Models

Model Name	GDT / Power
EMP-Protector-N(f)-N(m)-90	90 V / 25 W
EMP-Protector-N(f)-N(m)-230	230 V / 150 W
EMP-Protector-N(f)-N(f)-90	90 V / 25 W
EMP-Protector-N(f)-N(f)-230	230 V / 150 W

EMP-Protector-N(f)-N(m)

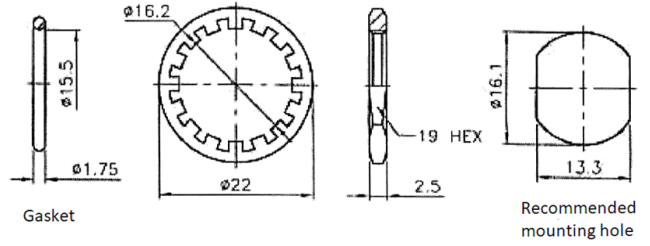
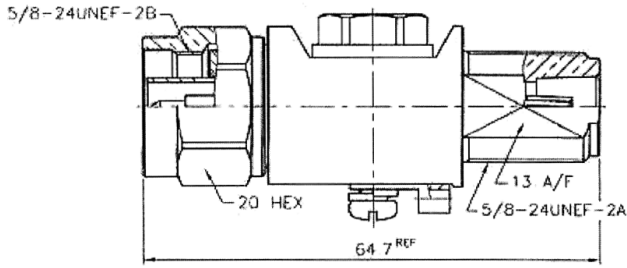

EMP-Protector-N(f)-N(f)

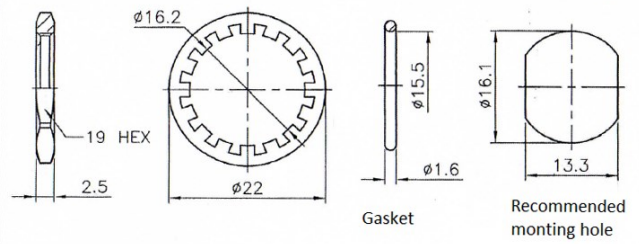
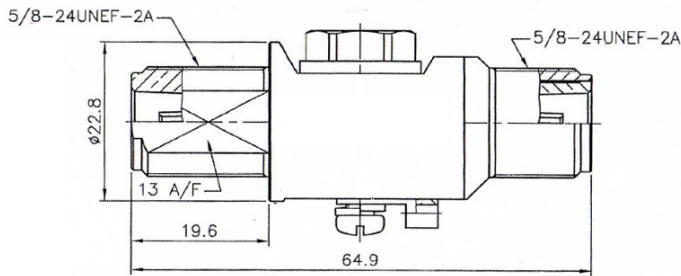

June 2021

All specifications are subject to change without notice
The information contained herein is for reference only and does not constitute a warranty of performance

Partnered Supplier



sales@eylex.com.au
www.eylex.com.au

