

GPS-VA

GPS vehicle antenna, L1/L2, 0.27 m, 1227 ± 10 MHz/1575.42 ± 10 MHz

Tactical Antennas: Vehicle Mount

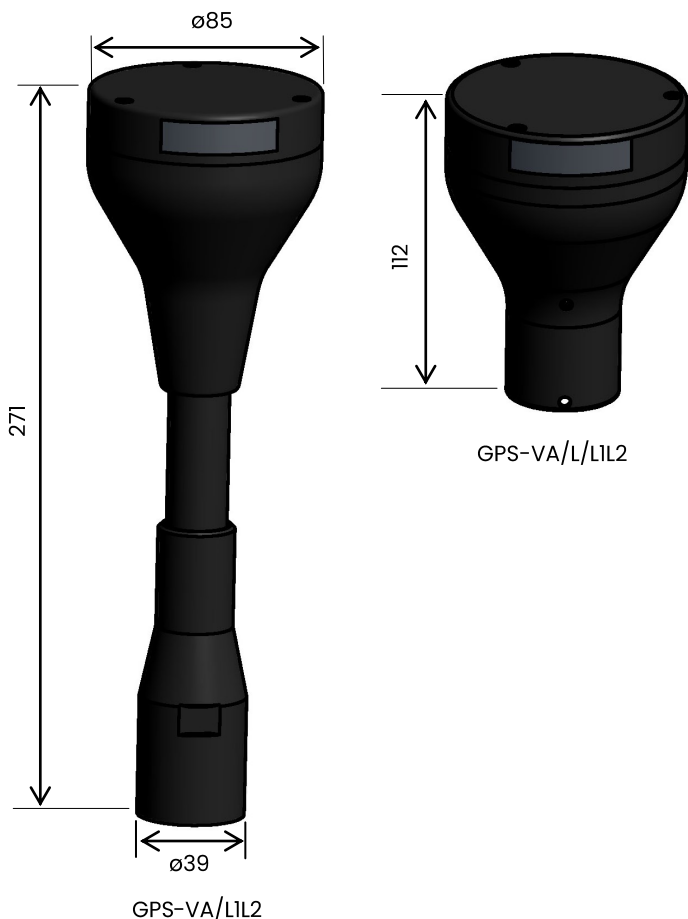

Application

Most GPS antennas for vehicles are flush mounted. Often this is undesirable as there are problems getting a 360° unobstructed view of the horizon as seen from the antenna. This is necessary for maximum performance from the GPS receiver. The height of this adaptor ensures an unobstructed view.

The antenna is available in two lengths.

The antenna can be used with different bases, with or without a spring.

The GPS L1/L2 antenna element is designed to handle strong radio signals nearby transmitters.

Specifications

GPS Frequency Range	GPS: L1/L2 1575 / 1227 ±10 MHz
GPS Preamplifier Gain	26.5 dB
GPS Noise Figure	2.5 dB
GPS Supply Voltage	2.7-5.5 V DC Current < 60 mA
Length	271 or 112 mm
Weight	» 0.75 kg
Finish	Polyurethane lacquer, black finish
Connector	Comrod VM-connection, 50Ω
Temperature Range	- 55°C to + 55°C
Design	GPS patch antenna. Uses stainless steel, brass and epoxy/fibreglass laminate.



Comrod VM-connection seen from antenna end

Available antenna bases for the antenna

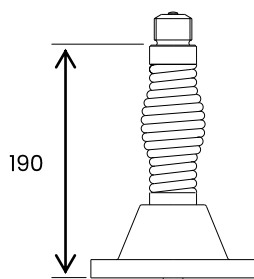

NATO base with spring

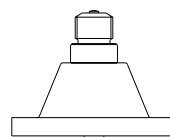

NATO base without spring

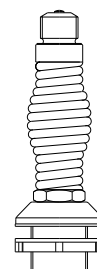

50mm hole, with spring

August 2019

All specifications are subject to change without notice
The information contained herein is for reference only and does not constitute a warranty of performance

Partnered Supplier



sales@eylex.com.au
www.eylex.com.au